

256.605.7

Variante standard / Standard option
61.1802.47
Ø1.5

Varianti / Options

10 e DA - 61.1802.45 Ø10
12 e DB - 61.1802.46 Ø12
18 e DC - 61.1802.48 Ø18
20 e DD - 61.1802.55 Ø20
D - 61.1802.47 Ø15

Variante standard / Standard option
Comune a tutte le versioni / Common for all models

73.602.22
NBR/Buna N

82.617.18
82.617.18 10
82.617.18 12
82.617.18 18
82.617.18 20
82.617.18 D
82.617.18 DA
82.617.18 DB
82.617.18 DC
82.617.18 DD

Varianti D DA DB DC DD
Options D DA DB DC DD

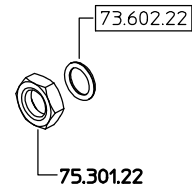
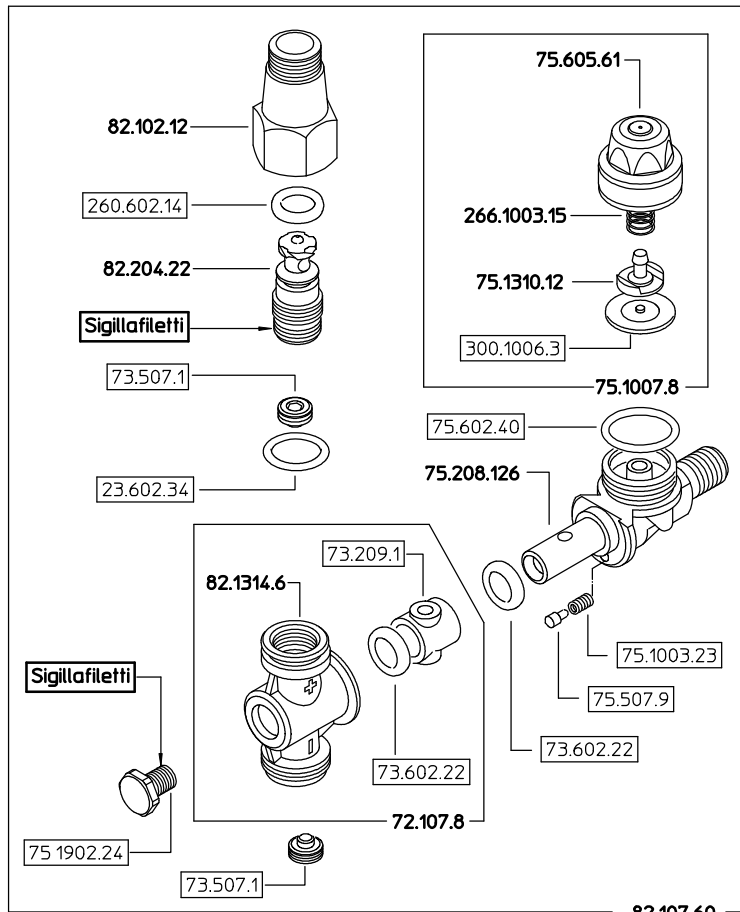
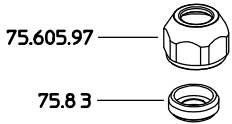

Solo per kit
Only for kit

23.602.34

68.602.10

73.602.22

260.602.14

Variante standard e 10 12 18 20
Standard option and 10 12 18 20

75.605.46
Ø15

Come si ordina/How to order
Kit ricambio
Spare parts kit **75.302.28**

Percorso file 3D:			
DENOMINAZIONE. Getto M82 G1/4M Ø15		N°revisione 03	Data revisione 05/02/08
Braglia srl	Tel. ++39 0522 340648 Fax ++39 0522 345025	STE	RTE
I-20129 Masone (REGGIO EMILIA)-ITALY-IE Email: braglia@braglia.it		82.617.18	